



SHERAZADE WALL PATCHWORK

**Informazioni pre-montaggio /
Pre-installation information**

Elenco generale dei componenti / General components list	pag.	13.1.102
Regolazioni parete / Wall adjustments	pag.	13.1.104
Rilievo misure / Measure survey	pag.	13.1.105

1. Profilo base orizzontale inferiore / Lower horizontal base profile
2. Profilo base orizzontale superiore / Upper horizontal base profile
3. Profilo cover base superiore / Cover upper base profile
4. Guarnizione magnetica base / Base magnetic gasket
5. Guarnizione magnetica cover / Cover magnetic gasket
6. Guarnizione battuta / Door striker gasket
7. Profilo stipite porta / Door jamb profile
8. Profilo traverso superiore di battuta (dove presente) / Upper striking crosspiece profile (where present)
9. Profilo centrostanza / Terminal jamb
10. Profilo a C a muro / "C" wall profile
11. Profilo telescopico a muro / Telescopic wall profile
12. Profilo cover stipite / Cover profile door jamb
13. Livellatore inferiore / Lower leveller
14. Clip in plastica / Plastic clip
15. Squadretta di allineamento [A] / Alignment bracket [A]
16. Squadretta di allineamento [B] / Alignment bracket [B]
17. Squadretta di allineamento [C] / Alignment bracket [C]
18. Staffa superiore (per traverso porta) / Upper bracket (for door cross piece)
19. Cerniera superiore / Upper hinge
20. Cerniera inferiore / Lower hinge
21. Cerniera superiore (per traverso porta) / Upper hinge (for door cross piece)
22. Cerniera superiore per profilo a muro / Upper hinge for wall profile
23. Cerniera inferiore per profilo a muro / Lower hinge for wall profile
24. Cerniera superiore per profilo a muro (per traverso porta) / Upper hinge for wall profile (for door cross piece)
25. Montante 2 vie / 2 ways jamb
26. Montante 3 vie / 3 ways jamb
27. Cerniera superiore per montante / Jamb upper hinge
28. Cerniera inferiore per montante / Jamb lower hinge
29. Cerniera superiore per montante (per traverso porta) / Jamb upper hinge (for door crosspiece)
30. Profilo di battuta a scatto per stipite / Snap striker profile
31. Profilo a scatto montante / Snap jamb profile
32. Modulo tecnico / Tech module
33. Coperchio per modulo tecnico / Cover for tech module

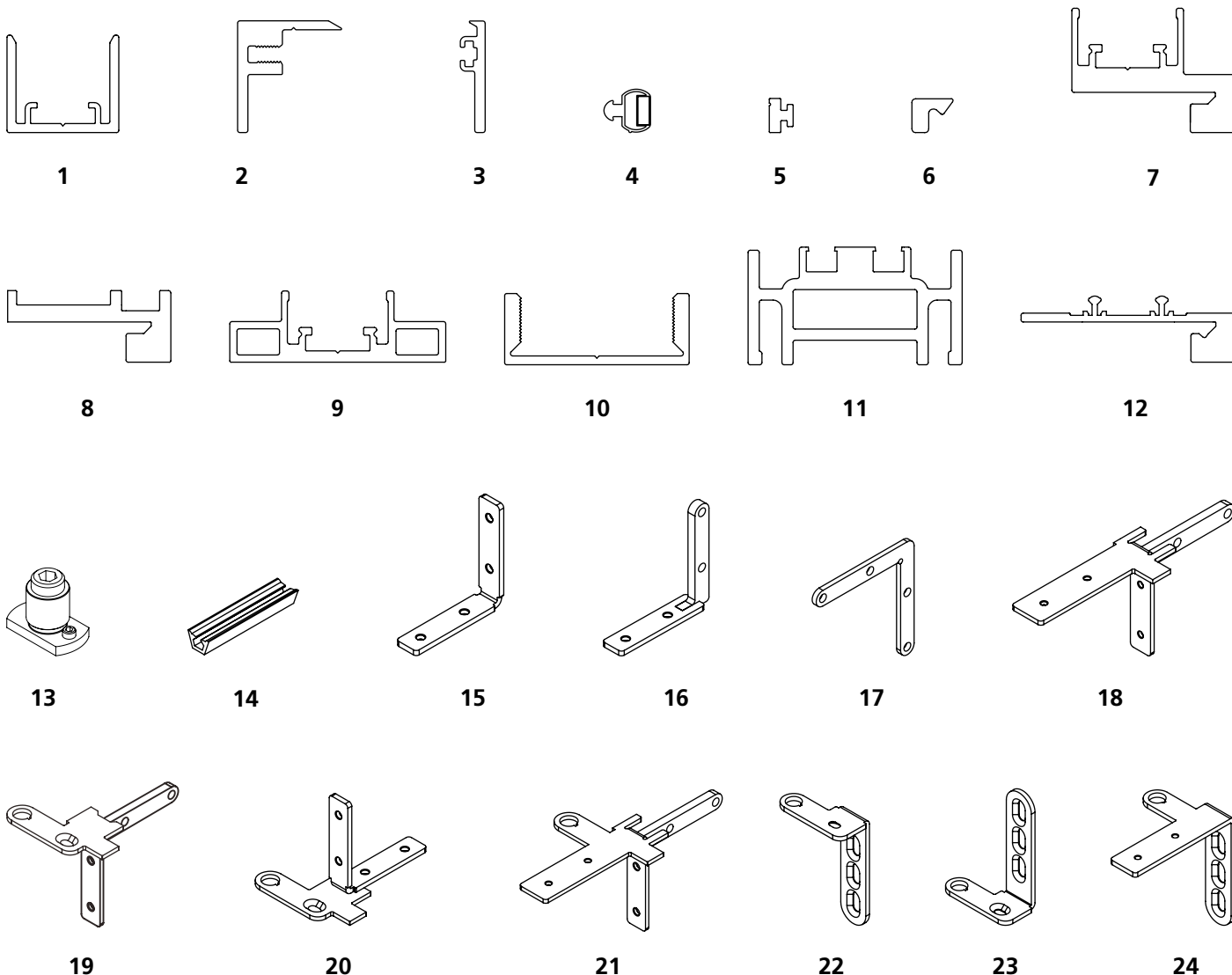

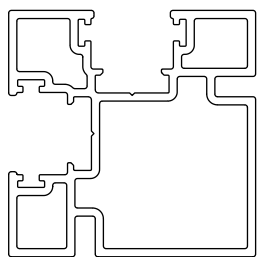

25

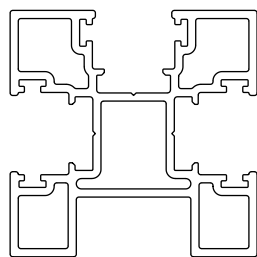

26

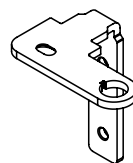

27

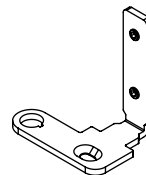

28

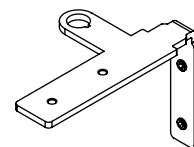

29

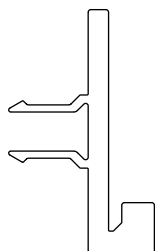

30



31



32



33

Regolazione della parete: Soffitto 10 mm. - Pavimento 10 mm. Regolazione totale 20mm.
Wall adjustment: Ceiling 10 mm. - Floor 10 mm. Total adjustment 20mm.

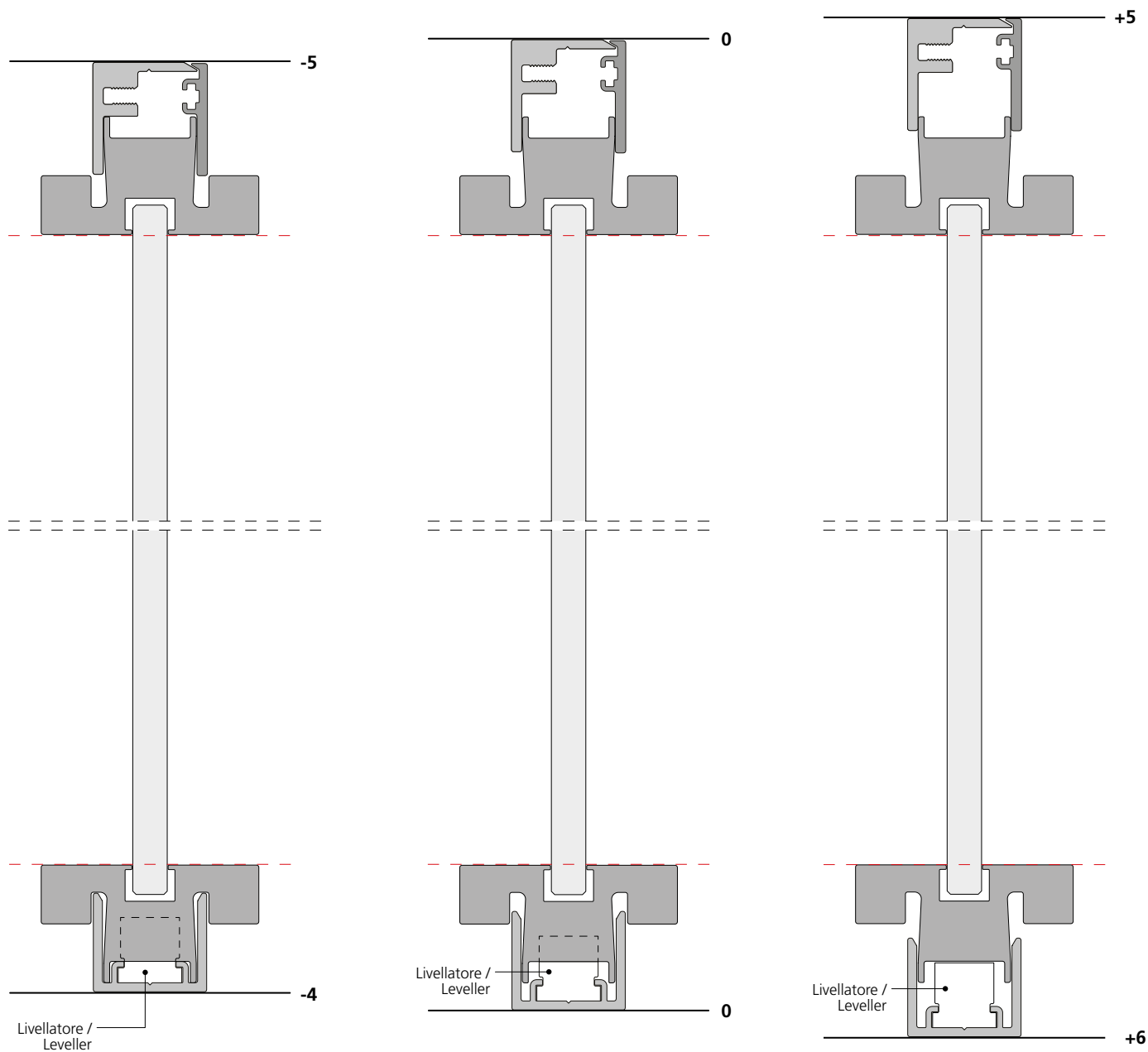

Posizione standard /
Standard position

Regolazione della parete:
Soffitto da -5 a +5 mm.
Pavimento da -4 a +6 mm.

Wall adjustment:
Ceiling from -5 to +5 mm.
Floor from -4 to +6 mm.

Rilievo misure / Measures survey

I rilievi per il sistema Aladin Wall devono essere eseguiti con precisione millimetrica utilizzando una livella laser. /
 Site surveys for the Aladin Wall partition system have to be made with accuracy to the millimetre and using a laser level.

Esempio / Example

● Punto per rilievo /
 Survey point

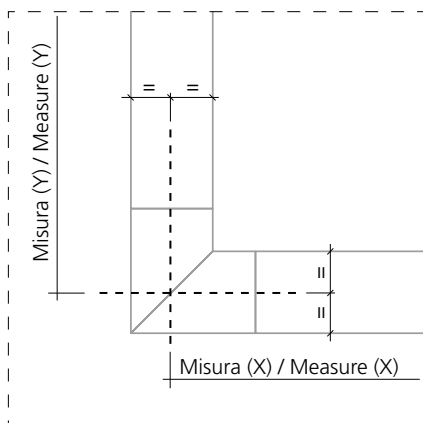
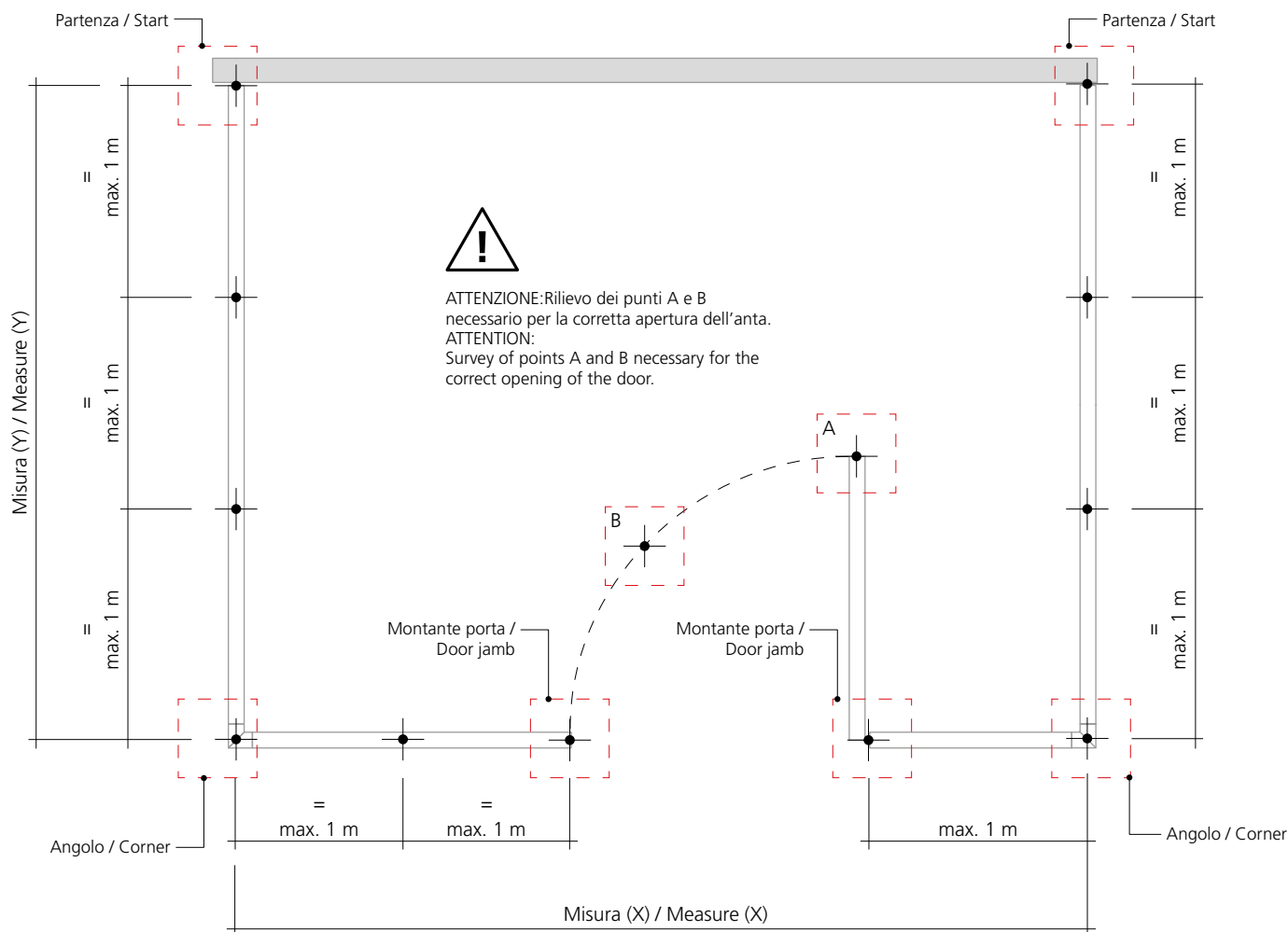

ATTENZIONE: il rilievo va eseguito sulla mezzzeria del profilo della parete vetrata. /
 ATTENTION: dimension must be taken on the profile centreline of the glass partition.

Il rilievo va eseguito a sezioni non superiori al metro ed in ogni caso in corrispondenza di angoli, giunzioni fra tratte, montanti porte, partenze a muro. / The survey must be done on sections no longer than a meter and in any case in correspondence of corner, join segments, door jambs and wall starting partition.

Tipologia pannelli Patchwork / Patchwork panel type

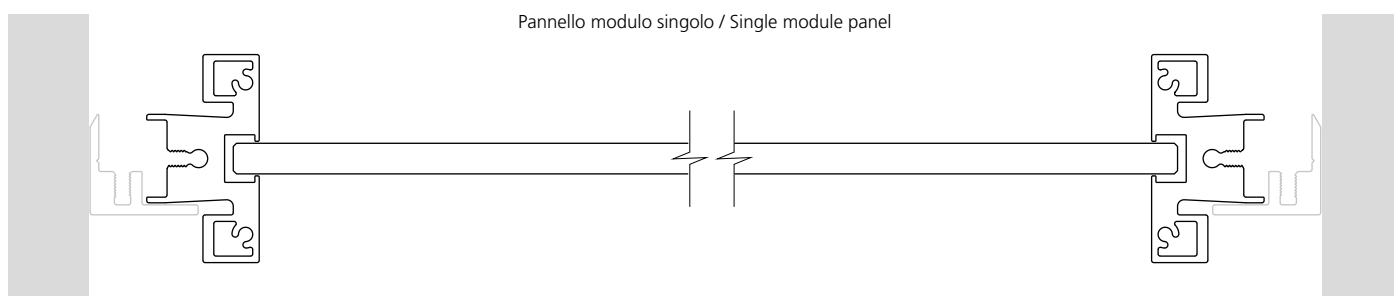
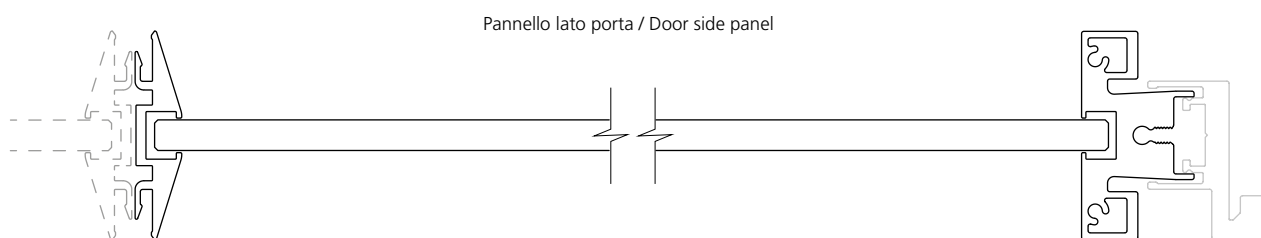
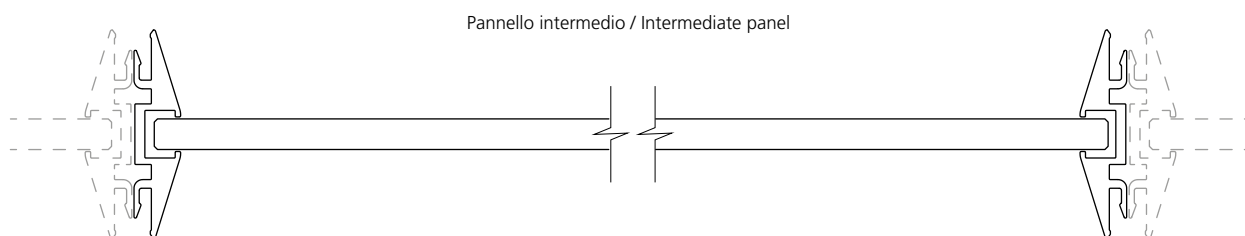
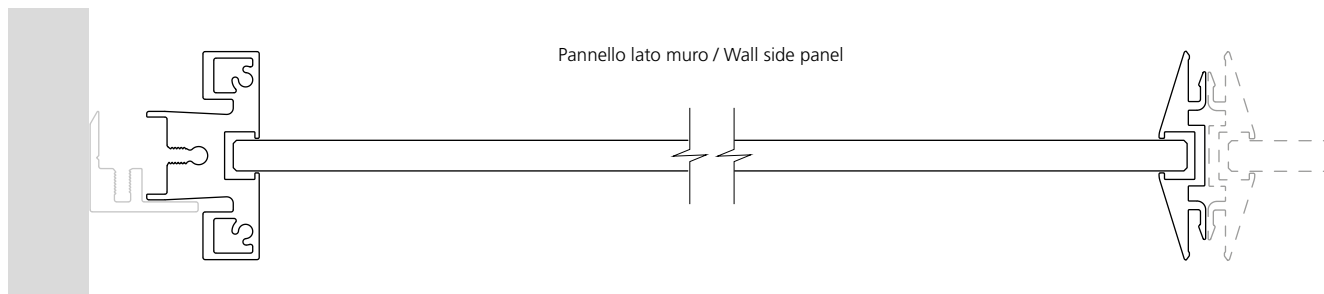

Nodi 2 vie e 3 vie / 2 and 3 ways joints

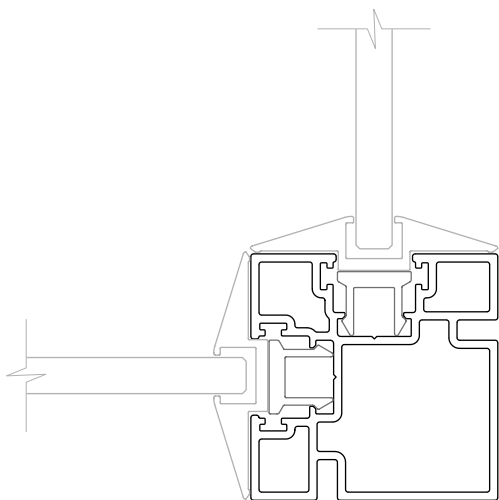

Nodo 2 vie / 2 ways joint

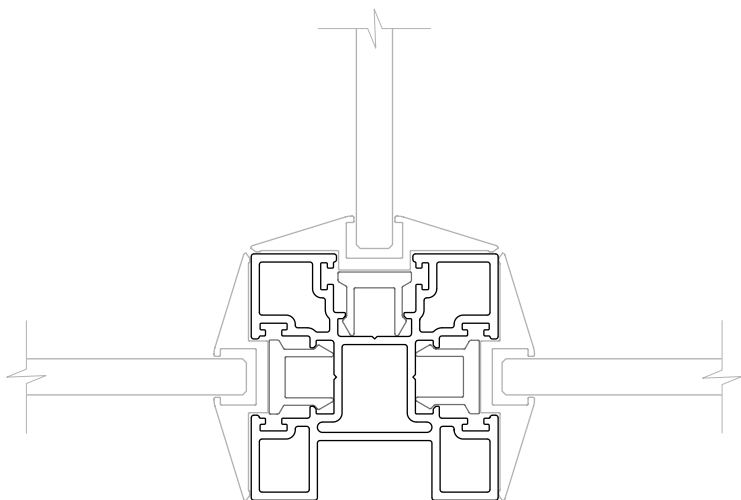

Nodo 3 vie / 3 ways joint

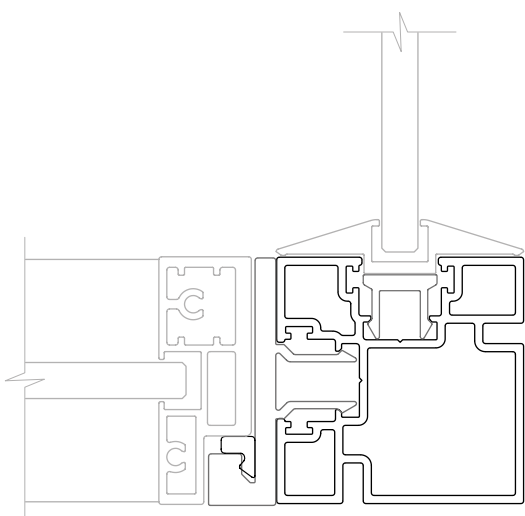

Nodo 2 vie con porta
battente / 2 ways joint
with swing door

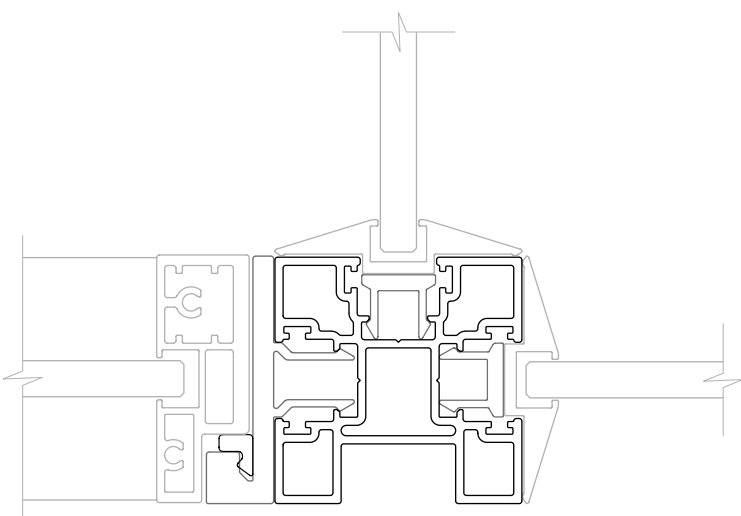

Nodo 3 vie con porta
battente / 3 ways joint
with swing door